

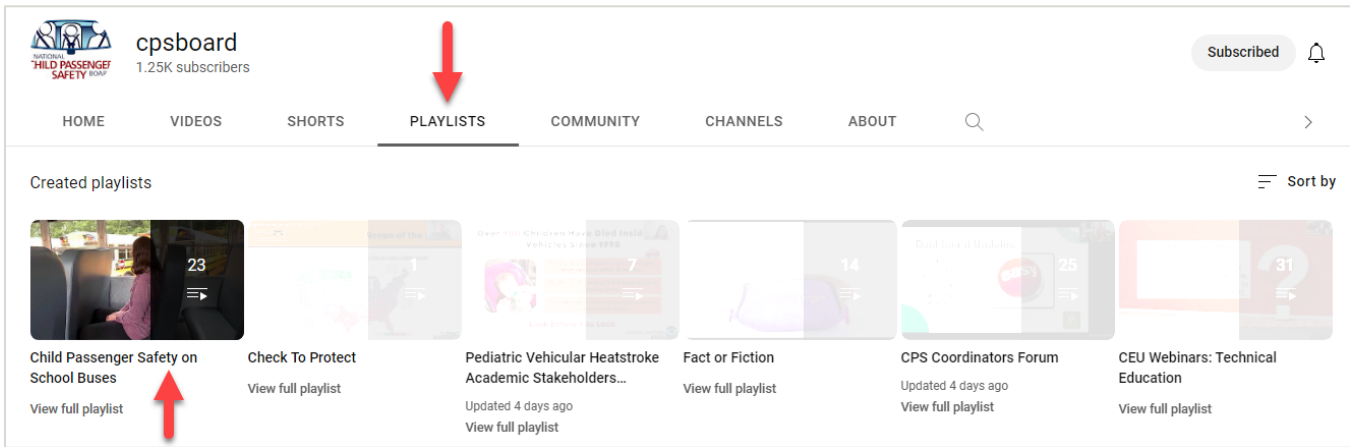

# Handout • CSRS Basics: Concepts and Features

## SCHOOL BUS VIDEO PLAYLIST ON YOUTUBE

- How-to videos for CSRS on school buses are available at the CPS Board YouTube Channel.  
[youtube.com/cpsboard](https://youtube.com/cpsboard)
  - Open the **Child Passenger Safety on School Buses** playlist.



## 5 STEPS WHEN USING CSRS

SELECTION	Choose the right car seat for the child AND the bus.
DIRECTION	Face the CSRS the right way.
LOCATION	Choose an appropriate location on the bus.
ADJUST/FIT	Adjust the CSRS to fit the child properly.
INSTALLATION	Secure the CSRS to the bus seating.

## SELECTION BASICS

What fits the **CHILD**?



What fits the **BUS**?

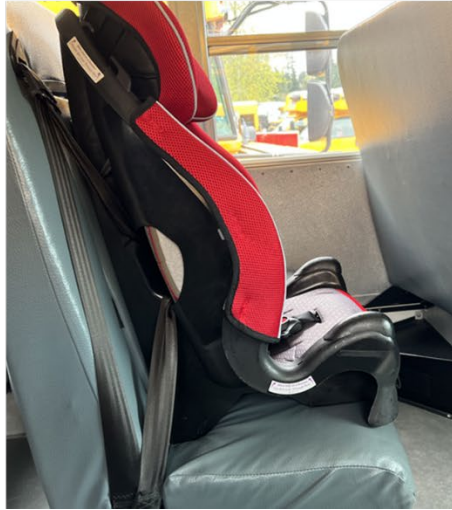

What **FEATURES** matter?

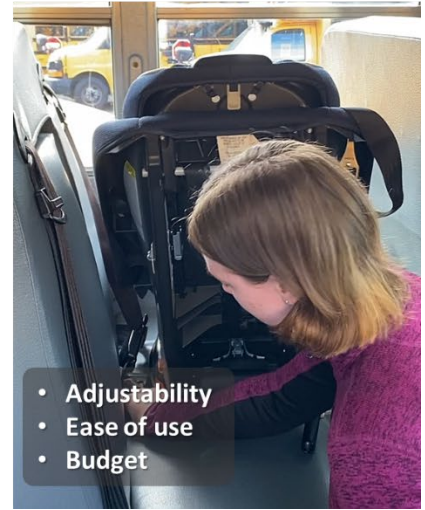

- Adjustability
- Ease of use
- Budget

## LOCATION BASICS

Choose a Location That Meets These Criteria



Enable a proper installation



Accommodate necessary child supervision



Consider all needs of the child

Consider needs and safety  
of other passengers



## Location and Emergency Evacuation Concerns



Do not use a row with an emergency exit to install a CSRS.



Place a CSRS next to the window if another child sits on the same bench seat.

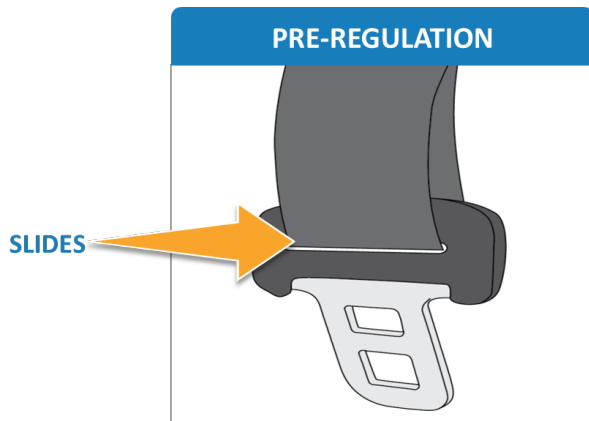

Sliding Latch Plate

**BEFORE** 10/2011

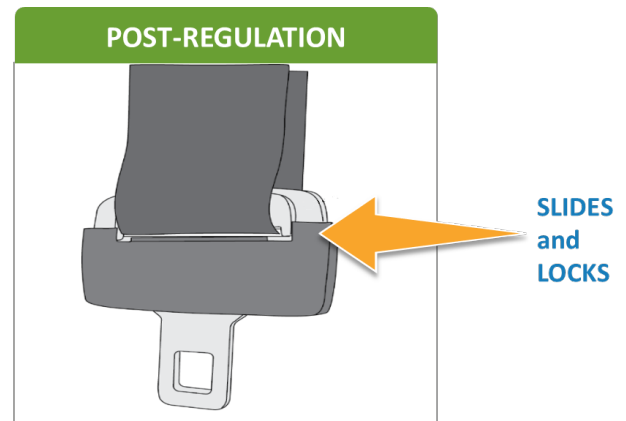

Locking Latch Plate

**SINCE** 10/2011

## MAINTENANCE: CLEAN CSRS PROPERLY

- Refer to the CSRS manufacturer's instructions before cleaning a CSRS, and strictly follow the cleaning instructions provided.
- Never use any chemicals (including, but not limited to, starch, bleach, alcohol, etc.) when cleaning CSRS, unless permitted explicitly by the CSRS manufacturer.
- Most chemicals weaken CSRS materials including plastic, webbing and buckles. Additionally, chemicals may wash the flame retardancy.
  - In general, use only mild soap and water to clean plastic, fabric and webbing.



- Rinse soap well and allow to thoroughly dry before reassembly and use.
  - Use only water on buckles.
  - Never use soap or lubricate buckles as this can cause them to malfunction.
  - However, do follow instructions to use water to clean buckles if gunk collects inside.
- Only air dry a CSRS harness or other parts made of webbing. Most padding must be air dried, too.
- Never iron webbing.

## PROGRESS CHECK

- What five steps of CSRS use should always be considered?
- What is the first thing to consider when selecting a CSRS?



## NOTES

[illegible]